

SEE BOTTOM RIGHT FOR TABLE CONTINUATION

ESMT	DESCRIPTION	RECORDING		ENTITLED	EXECUTED BY / IN FAVOR OF / RESERVED BY / GRANTED TO
		NO.	DATE		
H	SEAWATER INTAKE/OUTFALL ESMT	1999-0347267	5/21/1999	ESMT & COVENANT AG	SDG&E & CABRILLO POWER LLC
		1999-0347268	5/21/1999	FACILITIES SERVICES AG	SDG&E & CABRILLO POWER LLC
		2003-0969988	8/12/2003	SHELL FISH HOLD HARMLESS AG	CARLSBAD AQUAFARMS INC.
I	SEAWATER OUTFALL ESMT (NOT PLOTTABLE)	1992-0072559	2/11/1992	ESMT & COVENANT AG	SDG&E & THE CITY OF CARLSBAD
		1999-0347267	5/21/1999	FACILITIES SERVICES AG	SDG&E & CABRILLO POWER LLC
		1999-0347268	5/21/1999	SHELL FISH HOLD HARMLESS AG	CARLSBAD AQUAFARMS INC.
J	FISH RETURN ESMT	1999-0347267	5/21/1999	ESMT & COVENANT AG	SDG&E & CABRILLO POWER LLC
		1999-0347268	5/21/1999	FACILITIES SERVICES AG	SDG&E & CABRILLO POWER LLC
		2003-0969988	8/12/2003	SHELL FISH HOLD HARMLESS AG	CARLSBAD AQUAFARMS INC.
L	DREDGING ESMT (NOT PLOTTABLE)	BOOK 2974, PG. 493	10/8/1948	AG RE: ACQUISITION OF EASEMENT AND OTHER MATTERS	W.D. CANNON
		BOOK 4821, PG. 209	4/15/1953		SDG&E
		R.S. NO. 17350	9/17/1968		ALLAN O. KELLY & SDG&E
		78-466720	10/27/1978	AG RE: ACQUISITION OF ESMT & OTHER MATTERS	STATE OF CALIFORNIA, ACTING THROUGH THE STATE LANDS COMMISSION & SDG&E
		4821	4/15/1983		SDG&E
		86-072936	2/25/1986		CITY OF CARLSBAD
R	PARKING & LAYDOWN ESMT (NOT PLOTTABLE)	88-226631	5/13/1988		CITY OF CARLSBAD
		1999-0347267	5/21/1999	ESMT & COVENANT AG	SDG&E & CABRILLO POWER LLC
		1999-0347268	5/21/1999	FACILITIES SERVICES AG	SDG&E & CABRILLO POWER LLC
		2003-0969988	8/12/2003	SHELL FISH HOLD HARMLESS AG	CARLSBAD AQUAFARMS INC.
		1999-0347267	5/21/1999	ESMT & COVENANT AG	SDG&E & CABRILLO POWER LLC
		1999-0347268	5/21/1999	FACILITIES SERVICES AG	SDG&E & CABRILLO POWER LLC
S	LAGOON INTAKE ESMT (NOT PLOTTABLE)	2003-0969988	8/12/2003	SHELL FISH HOLD HARMLESS AG	CARLSBAD AQUAFARMS INC.
		1999-0347267	5/21/1999	ESMT & COVENANT AG	SDG&E & CABRILLO POWER LLC
		1999-0347268	5/21/1999	FACILITIES SERVICES AG	SDG&E & CABRILLO POWER LLC
T	TEMPORARY INTAKE SCREENING, PUMPING, & DISCHARGE ESMT	2003-0969988	8/12/2003	SHELL FISH HOLD HARMLESS AG	CARLSBAD AQUAFARMS INC.
		1999-0347267	5/21/1999	ESMT & COVENANT AG	SDG&E & CABRILLO POWER LLC
		1999-0347268	5/21/1999	FACILITIES SERVICES AG	SDG&E & CABRILLO POWER LLC
U	RETAINING WALL ESMT (NOT PLOTTABLE)	2003-0969988	8/12/2003	SHELL FISH HOLD HARMLESS AG	CARLSBAD AQUAFARMS INC.
		1999-0347267	5/21/1999	ESMT & COVENANT AG	SDG&E & CABRILLO POWER LLC
		1999-0347268	5/21/1999	FACILITIES SERVICES AG	SDG&E & CABRILLO POWER LLC

STANDARD PROJECT APPLICABLE BMPS

- SC-1 PREVENTION OF ILLICIT DISCHARGES INTO THE MS4
- SC-2 STORM DRAIN STENCILING OR SIGNAGE
- SC-6 ON-SITE STORM DRAIN INLETS
- SC-6 OUTDOOR STORAGE OF EQUIPMENT OR MATERIALS
- SC-6 PLAZAS, SIDEWALKS, AND PARKING LOTS
- SD-1 MAINTAIN NATURAL DRAINAGE PATHWAYS AND HYDROLOGIC FEATURES
- SD-3 MINIMIZE IMPERVIOUS AREA
- SD-5 IMPERVIOUS AREA DISPERSION
- SD-6 RUNOFF COLLECTION

NOTE:

1. THE PROPOSED DILUTION PUMP STATION WILL BE CONSTRUCTED WITHIN THE EXISTING BELOW GRADE INTAKE/DISCHARGE STRUCTURE. THE TOP OF THE EXISTING STRUCTURE IS AT GRADE. THE PUMP STATION WILL CONSIST OF THREE PUMPS AND ASSOCIATED PIPING.
2. PER SEPARATE PERMIT (RW 2019-1121) AT THE CONCLUSION OF PROJECT CONSTRUCTION ACTIVITIES, TEMPORARY DRIVEWAY SHALL BE REMOVED AND AREA RESTORED TO PRE-CONSTRUCTION CONDITIONS. RESTORED CURB & GUTTER AND SIDEWALK SHALL BE PER SDRSD STD. DWG G-2 AND G-7.

ESMT	DESCRIPTION	RECORDING		ENTITLED	EXECUTED BY / IN FAVOR OF / RESERVED BY / GRANTED TO
		NO.	DATE		
C	WATER PLANT INTAKE/DISCHARGE ESMT	1999-0347267	5/21/1999	ESMT & COVENANT AG	SDG&E & CABRILLO POWER LLC
		1999-0347268	5/21/1999	FACILITIES SERVICES AG	SDG&E & CABRILLO POWER LLC
		2003-0969988	8/12/2003	SHELL FISH HOLD HARMLESS AG	CARLSBAD AQUAFARMS INC.
D	CONNECTION ESMT	1992-0072559	2/11/1992	ESMT & COVENANT AG	SDG&E & THE CITY OF CARLSBAD
		1999-0347267	5/21/1999	FACILITIES SERVICES AG	SDG&E & CABRILLO POWER LLC
		2003-0969988	8/12/2003	SHELL FISH HOLD HARMLESS AG	CARLSBAD AQUAFARMS INC.
E	PRODUCT WATER PIPELINE ESMT (NOT PLOTTABLE)	BOOK 2974, PG. 493	10/8/1948		W.D. CANNON
		BOOK 4722, PG. 361	1/21/1953		W.D. CANNON
		1992-0072559	2/11/1992		SDG&E & THE CITY OF CARLSBAD
		1992-802206	12/15/1992		ATS&F
		1992-802209	12/15/1992		MARINERS CAPITAL, INC.
		1997-0550827	11/3/1997		SDG&E & CABRILLO POWER LLC
F	SEWER/DOMESTIC WATER ESMT (NOT PLOTTABLE)	1999-0347267	5/21/1999	ESMT & COVENANT AG	SDG&E & CABRILLO POWER LLC
		1999-0347268	5/21/1999	FACILITIES SERVICES AG	SDG&E & CABRILLO POWER LLC
		2003-0969988	8/12/2003	SHELL FISH HOLD HARMLESS AG	CARLSBAD AQUAFARMS INC.
		2003-1411261	11/25/2003	ESMT AG	SDG&E & CABRILLO POWER LLC
		BOOK 147, PG. 152	7/26/1932		SOUTHERN COUNTIES GAS CO.
		BOOK 1200, PG. 421	8/2/1941		SOUTHERN CALIFORNIA TELEPHONE CO.
F	SEWER/DOMESTIC WATER ESMT (NOT PLOTTABLE)	BOOK 2974, PG. 493	10/8/1948		W.D. CANNON
		112575	6/23/1964		THE VISTA SANITATION DISTRICT & THE CITY OF CARLSBAD
		INSTRUMENT NO. 113886	6/24/1964		THE VISTA SANITATION DISTRICT & THE CITY OF CARLSBAD
		1992-802206 & 1992-802209	12/15/1992		ATS&F
		1997-0550827	11/3/1997		MARINERS CAPITAL, INC.
		1999-0347267	5/21/1999	ESMT & COVENANT AG	SDG&E & CABRILLO POWER LLC
		1999-0347268	5/21/1999	FACILITIES SERVICES AG	SDG&E & CABRILLO POWER LLC
		2003-0969988	8/12/2003	SHELL FISH HOLD HARMLESS AG	CARLSBAD AQUAFARMS INC.

SEE TOP LEFT FOR TABLE CONTINUATION

RECORD DRAWINGS

These Record Drawings have been prepared based on information submitted. In part, by others. While this information is believed to be reliable, Tetra Tech is not responsible for its accuracy, nor for errors or omissions which may have been incorporated into these plans as a result.

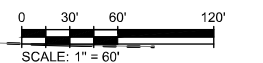

Proposed to be used in the initial phase of construction. The area will be closed for parking when needed by NRG

- AREAS OF CONSTRUCTION
- CONTRACTOR'S TRAILERS/LAYDOWN/PARKING

Proposed temp fish farm access driveway and parking. To be made available prior to start of construction.

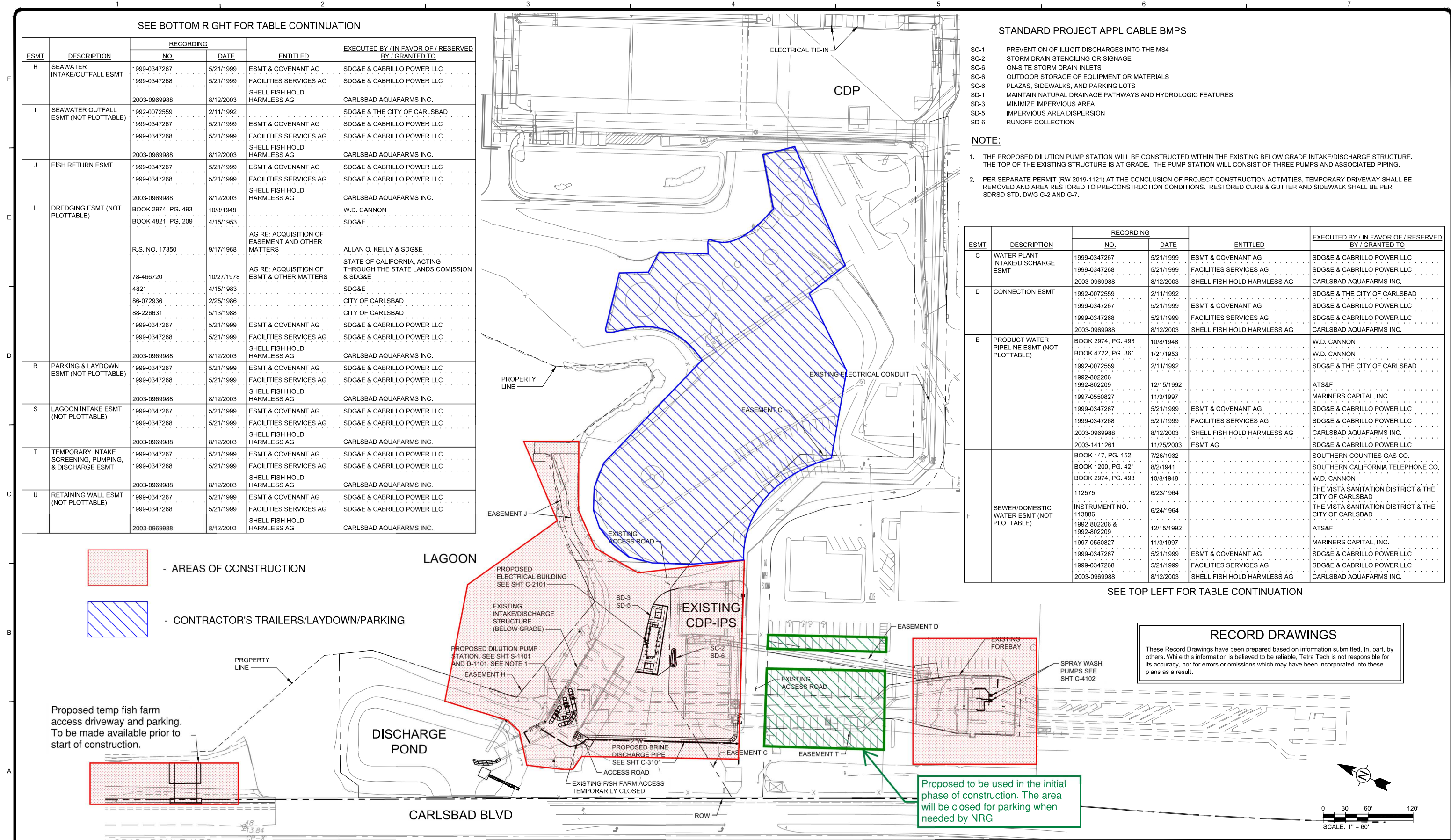

<p><b>Kiewit - Shea</b> a Joint Venture</p>	<p><b>TETRA TECH</b> www.tetrattech.com 17885 Von Karman Ave, Suite 500 Irvine, CA 92614 Tel: (949) 809-5000 Fax: (949) 809-5010</p>	RECORD DRAWING	3/18/20	<table border="1" style="width: 100%;"> <tr> <th>MARK</th> <th>DATE</th> <th>DESCRIPTION</th> <th>BY</th> </tr> <tr> <td>1</td> <td>2020/08/07</td> <td>RECORD DRAWING</td> <td>SDT</td> </tr> </table>	MARK	DATE	DESCRIPTION	BY	1	2020/08/07	RECORD DRAWING	SDT	<p>POSEIDON CHANNELSIDE CARLSBAD DESALINATION PLANT INTAKE PUMP STATION PHASE 1 OVERALL SITE PLAN <b>Figure 4</b></p>	<p>PROJ: 200-35200-19001 DESN: KAB DRWN: WVP/J CHKD: SDT</p> <p style="font-size: 2em; font-weight: bold;">C-0100</p>
		MARK	DATE	DESCRIPTION	BY									
1	2020/08/07	RECORD DRAWING	SDT											
<p>Bar measures 1 inch, otherwise drawing not to scale</p>														

8/10/2020 1:55:24 PM - C:\PROJECTS\IRVINE\35200\200-35200-19001\CAD\SHSHEETFILES\C-0100 OVERALL SITE PLAN.DWG - JOHNSON, WILLIE